

Taping Specification

SOT 223 (1)

DimensionTable for SOT-223 Punched Carrier Reel Camber

Symbol	Inches		Millimeters		Notes
	Min.	Max.	TYP.		
D0	-	-	1.54	-	
D1	-	-	1.485	-	
P0	-	-	4.083	-	
P2	-	-	1.985	-	
P1	-	-	6.01	-	
T Max.	-	-	0.29	-	
T1	-	-	0.06	-	
T2	-	-	2.11	-	
B1	-	-	7.28	-	
E	-	-	1.769	-	
F	-	-	5.522	-	

Symbol	Inches		Millimeters		Notes
	Min.	Max.	TYP.		
r	-	-	40.87	-	
G2	-	-	0.3	-	
G1	-	-	0.3	-	
W	-	-	12.046	-	
A0	-	-	6.45	-	
B0	-	-	7.15	-	
K0	-	-	1.96	-	
N	-	-	9.02	-	
Tape size	-	-	-	-	8mm and 12mm

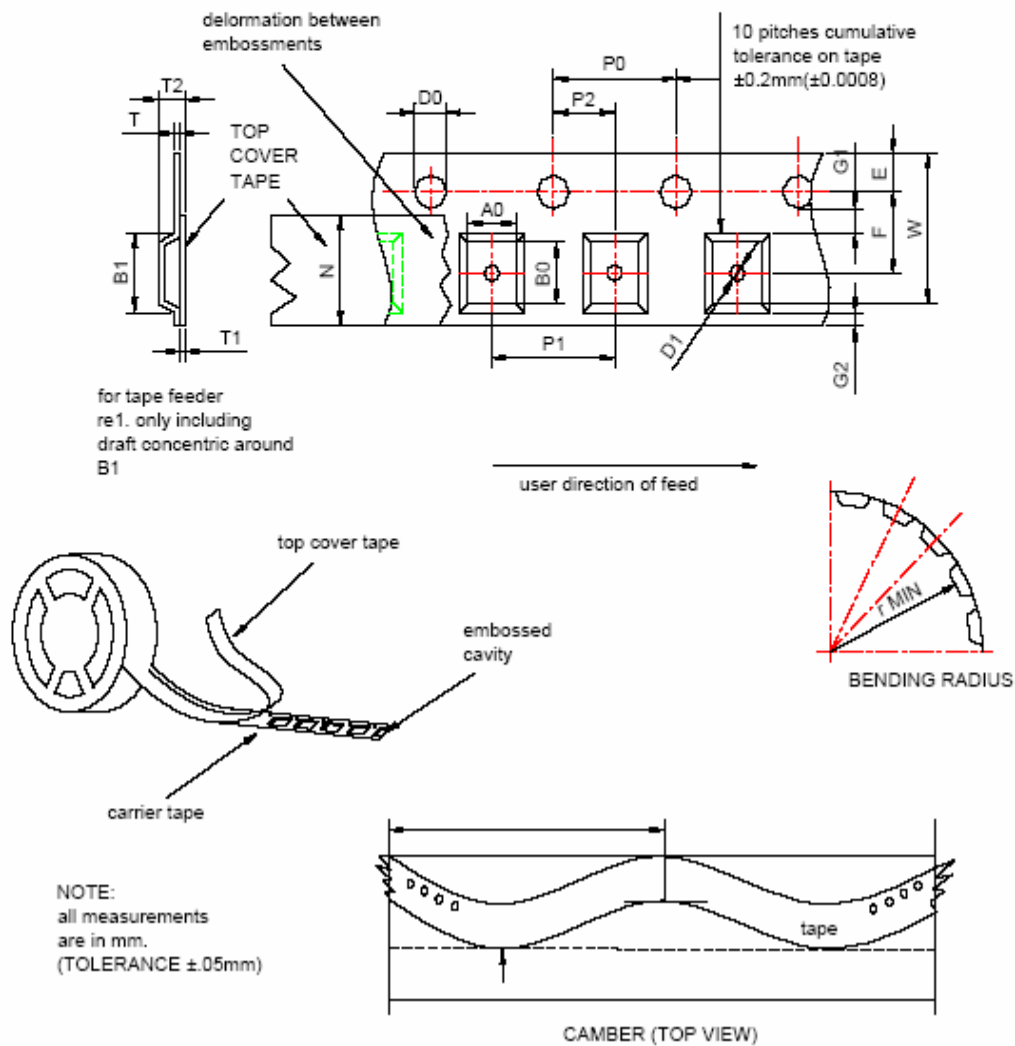

Taping Specification

SOT 223 (2)

DimensionTable for SOT-223 Punched Carrier Reel Camber

SOT-223 Reel Configuration

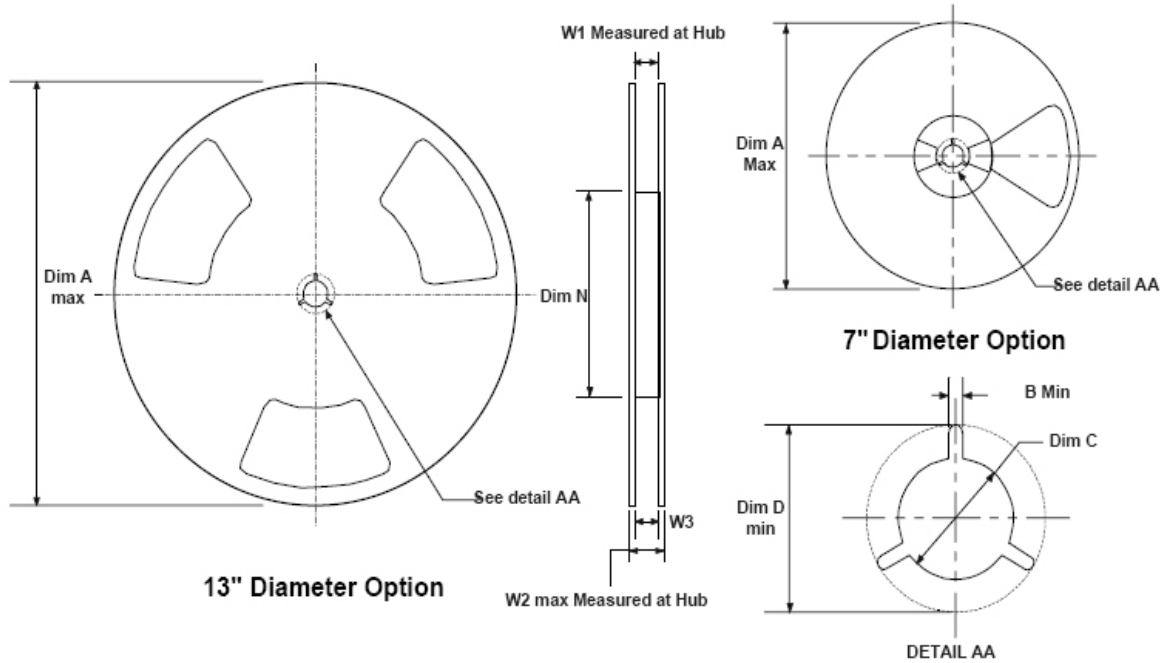

Dimensions are in inches and millimeters									
Tape Size	Reel Option	Dim A	Dim B	Dim C	Dim D	Dim N	Dim W1	Dim W2	Dim W3 (LSL-USL)
12mm	7" Dia	7.00 177.8	0.050 1.5	512 +0.020/-0.008 13 +0.5/-0.2	0.795 20.2	5.906 150	0.488 +0.078/-0.000 12.4 +2/0	0.724 18.4	0.480 - 0.600 11.9 - 15.4
12mm	13" Dia	13.00 330	0.050 1.5	512 +0.020/-0.008 13 +0.5/-0.2	0.795 20.2	7.00 178	0.488 +0.078/-0.000 12.4 +2/0	0.724 18.4	0.480 - 0.600 11.9 - 15.4